



**US Army Corps  
of Engineers**  
Louisville District ®

# Public Notice

---

Public Notice No.  
LRL-2008-950

Open Date:  
22 May 2014

CloseDate:  
23 Jun 2014

---

Please address all comments and inquiries to:  
U.S. Army Corps of Engineers, Louisville District  
ATTN: Ms. Pam Loeffler, CELRL-OP-FS, Rm 752  
P.O. Box 59  
Louisville, Kentucky 40201-0059

Phone: 502-315-6693

---

This notice announces an application submitted for a Department of the Army (DA) Permit, subject to Section 10 of the Rivers and Harbors Act of 1899:

APPLICANT: Hilltop Basic Resources, Incorporated  
Hilltop Big Bend Quarry  
1 West 4<sup>th</sup> Street, Suite 1100  
Cincinnati, Ohio 45202

LOCATION: On the left bank of the Ohio River at Mile 660;  
at 1994 Paradise Bottom Road in Battletown, Meade  
County, Kentucky 40104

Latitude: 38.1573  
Longitude: -86.2977  
7.5 Minute Quad: IN-Leavenworth

PURPOSE: To reconfigure the fleeting arrangements for 47  
barges with the installation of 5 additional  
dolphins along newly acquired 600 linear feet of  
riverfront property at the upstream end of the  
existing barge terminal facility.

DESCRIPTION OF WORK: This existing barge loading terminal has  
acquired 600 linear feet of additional property at its upstream end.  
Five additional dolphins would be installed to expand terminal  
operations and improve operational safety and efficiency. One dolphin  
would be placed at the midpoint of the existing configuration and four  
additional dolphins would be added to the upstream end of the  
property. Empty barges would be secured to the upstream dolphins,  
rather than utilizing the existing deadmen on the downstream end. The  
additional dolphin at the midpoint shown on Sheet 3 of 6 would allow  
safer and more secure staging of loaded barges.

The fleeting arrangement would be shifted upriver approximately 600  
linear feet in front of the newly acquired property. The total number  
of barges present at one time would remain at 47, and would be  
configured as shown on Sheet 1 of 6 of the attached plans. The  
fleeting arrangement shown on Sheet 2 of 6 for the west (downstream)

end of the facility depicts the maximum number of barges for that location in the event some of the 47 barges need to be moved to that end during staging. The maximum riverward projection for this facility at normal pool would be 192 feet.

REVIEW PROCEDURES: A DA Permit cannot be issued if any legally required Federal, State, or local authorization or certification is denied.

Copies of this notice are sent to the appropriate Federal and State Fish and Wildlife Agencies. Their views and comments are solicited in accordance with the Fish and Wildlife Coordination Act of 1956. Based on available information, the proposed activity will not destroy or endanger any Federally-listed threatened or endangered species or their critical habitats, as identified under the Endangered Species Act, and therefore, initiation of formal consultation procedures with the U.S. Fish and Wildlife Service is not planned at this time.

Any person may request, in writing, within the comment period specified in this notice, that a public hearing be held to consider this application. A request for a public hearing must state the specific interest which might be damaged by issuance of the DA Permit.

The National Register of Historic Places has been examined, and it has been determined that there are no properties currently listed on the Register which would be directly affected by the proposed work. If we are made aware, as a result of comments received in response to this notice, or by other means, of specific archaeological, scientific, prehistoric, or historical sites or structures which might be affected by the proposed work, the District Engineer will immediately take the appropriate action necessary pursuant to the National Historic Preservation Act of 1966 - Public Law 89-665 as amended (including Public Law 96-515).

The decision whether to issue a permit will be based on an evaluation of the probable impact of the proposed activity on the public interest. That decision will reflect the national concern for both protection and utilization of important resources. The benefits which reasonably may be expected to accrue from the proposal must be balanced against its reasonably foreseeable detriments. All factors which may be relevant to the proposal will be considered; among those are conservation, economics, aesthetic values, general environmental concerns, historic values, fish and wildlife values, flood damage prevention, land use, navigation, recreation, water supply, water quality, energy needs, safety, food production, and in general, the needs and welfare of the public

The Corps of Engineers is soliciting comments from the public; Federal, State, and local agencies and officials; Indian tribes; and

other interested parties in order to consider and evaluate the impacts of this proposed activity. It is presumed that all interested parties and agencies will wish to respond; therefore, a lack of response will be interpreted as meaning that there is no objection to the proposed project. Any comments received will be considered by the Corps of Engineers to determine whether to issue, modify, condition or deny a permit for this proposal. To make this decision, comments are used to assess impacts on endangered species, historic properties, water quality, general environmental effects, and the other public interest factors listed above. Comments are used in the preparation of an Environmental Assessment and/or an Environmental Impact Statement pursuant to the National Environmental Policy Act. Comments are also used to determine the need for a public hearing and to determine the overall public interest of the proposed activity.

Written statements received in this office on or before the closing date will become a part of the official record and will be considered in the determination on this permit request. Any objections which are received during this period will be forwarded to the applicant for possible resolution before the determination is made whether to issue or deny the requested DA Permit. A permit will be granted unless its issuance is found to be contrary to the public interest.

Information pertaining to this application is available for public examination during normal business hours upon prior request. Drawings are available on Louisville District's Internet site at <http://www.lrl.usace.army.mil/Missions/Regulatory.aspx>. All comments regarding this proposal should be addressed to Ms. Pam Loeffler, CELRL-OP-FS at the address noted above and should refer to the Public Notice Number LRL-2008-950-pjl.

If you desire to submit your comments by email, you must comply with the following:

a) In the subject line of your email, type in **ONLY** the Public Notice ID No. LRL-2008-950-pjl.

Example:

Subject: LRL-2008-950-pjl

b) Provide your physical mailing address and telephone number.

c) Send your email to: [lrl.regulatorypubliccomment@usace.army.mil](mailto:lrl.regulatorypubliccomment@usace.army.mil).

d) If you are sending attachments greater than 1 Mb in size with your email, you must send a hard copy (CD or paper) to the Corps' physical address as well.



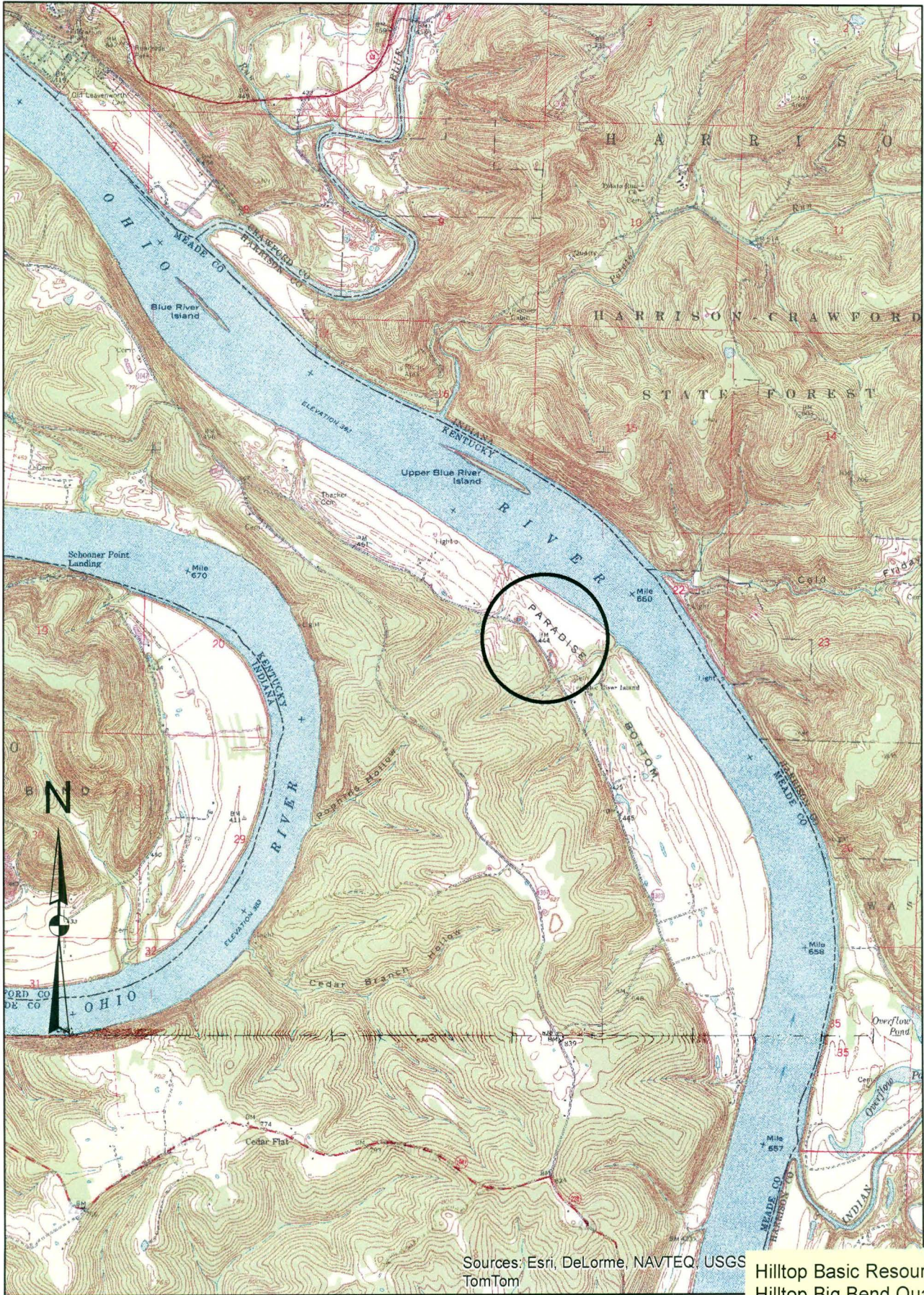

Sources: Esri, DeLorme, NAVTEQ, USGS, TomTom



Project Location  
Lat 38.15268; Long. -86.29285

1 inch = 0.69 miles

Hilltop Basic Resources Inc.  
Hilltop Big Bend Quarry  
Ohio River Mile 660, Left Bank  
Meade County, KY  
Public Notice LRL-2008-950



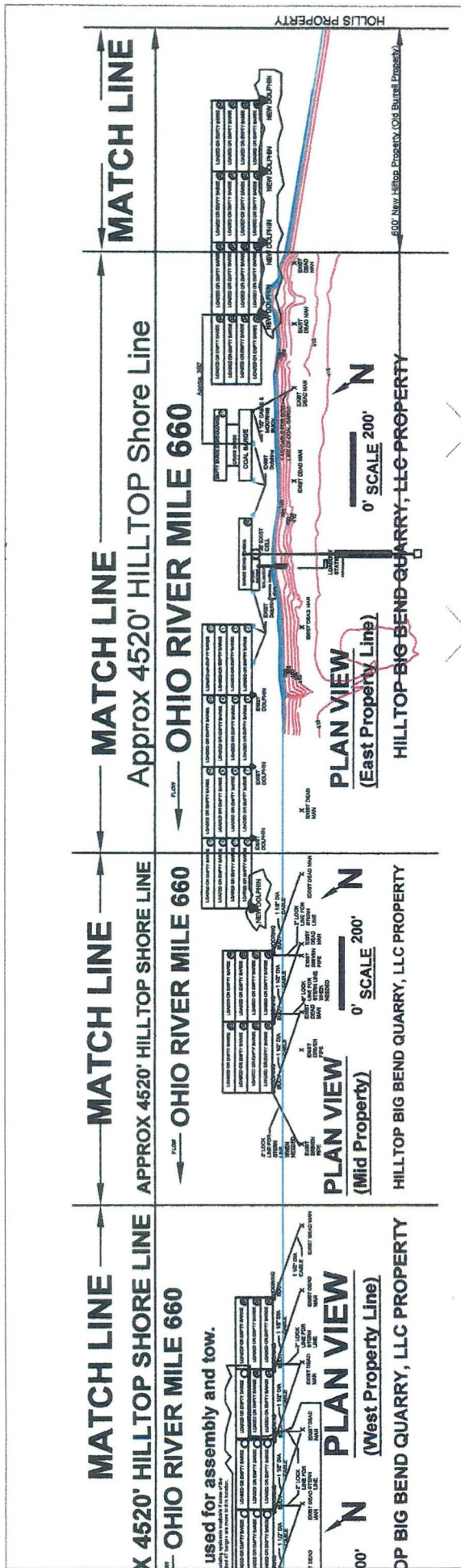

*R. Dan Corner, P.E.*  
4/30/2014

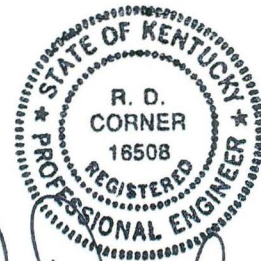

**HILLTOP COMPANIES, INC.**  
HILLTOP BASIC RESOURCES, INC.  
HILLTOP CONCRETE  
MAYSVILLE READY MIX  
HILLTOP STONE, LLC  
HILLTOP BIG BEND QUARRY, LLC

ONE WEST FOURTH STREET  
SUITE 1100  
CINCINNATI, OH 45202

**HILLTOP COMPANIES, INC.**  
HILLTOP BIG BEND QUARRY, LLC  
1994 Paradise Bottom Rd  
Battletown, KY 40104  
**BARGE LOADING FACILITY**  
OHIO RIVER MILE 660  
**TOTAL PLAN VIEW**

Date  
Rev: 04/30/14

Drawn By  
R. Dan Corner, PE

Phone  
(513) 684 - 8247

Sheet

200808005

Sheet 1 of 6

**MATCH LINE** →

**APPROX 4520' HILLTOP SHORE LINE**

**NOTE!**  
**OHIO RIVER MILE 660**

**This area used for assembly and tow.**

This existing system is available if some of the permitted 47 barges are move to this location.

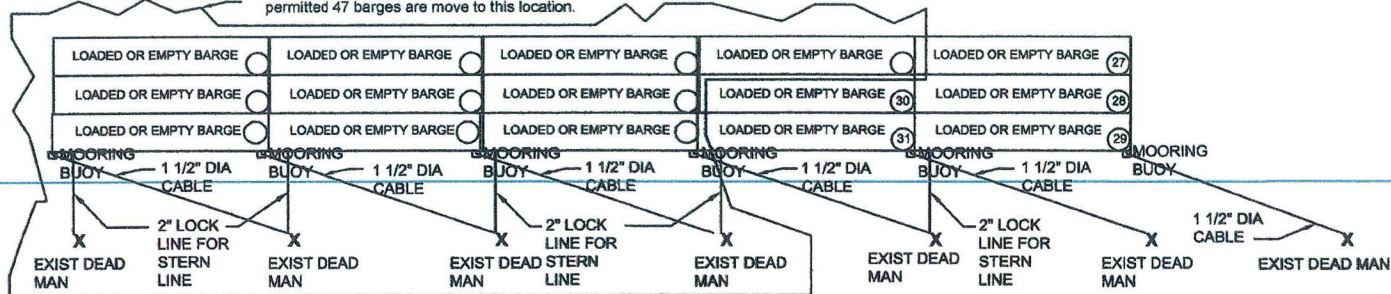

**POPHAM PROPERTY**

**0' 200'**

**SCALE**

**N**

**PLAN VIEW**

**(West Property Line)**

**HILLTOP BIG BEND QUARRY, LLC PROPERTY**

Date 04/30/14	Sheet 200808003
Drawn By R. Dan Corner, P.E.	Sheet 2 of 6
Project (513) 684 - 8247	

HILLTOP COMPANIES, INC. HILLTOP BIG BEND QUARRY, LLC 1984 Paradise Bottom Rd Bartlettown, KY 40104 BARGE LOADING FACILITY OHIO RIVER MILE 660 WEST PLAN VIEW
--

HILLTOP COMPANIES, INC. HILLTOP BASIC RESOURCES, INC. HILLTOP CONCRETE MAYSVILLE READY MIX HILLTOP STONE, LLC HILLTOP BIG BEND QUARRY, LLC ONE WEST FOURTH STREET SUITE 1100 CINCINNATI, OH 45202
---

**NOTES:**  
See notes Sheet 4 of 6.

*4/30/2014*  
*R. Dan Corner, P.E.*

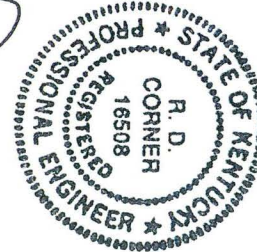



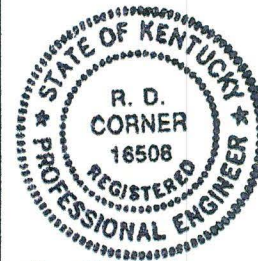
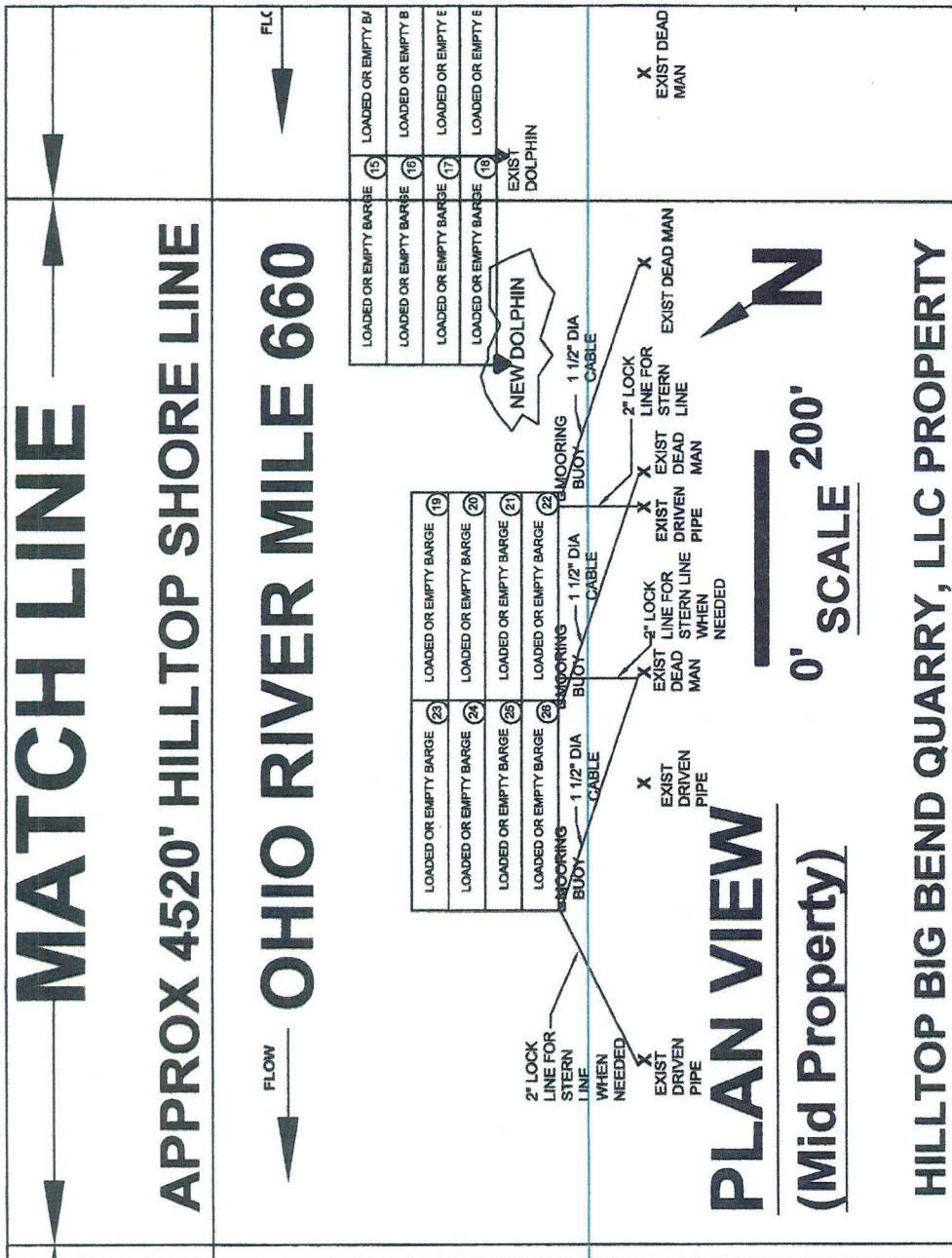

*R. Dan Corner, P.E.*  
4/30/2014

#### NOTES:

See notes Sheet 4 of 6.  
1 New Dolphin Proposed on Sheet 3 of 6  
4 New Dolphins Proposed Sheet 5 of 6  
(See views)

DOLPHIN ENGINEERING AND DESIGN  
BY DOLPHIN CONTRACTOR

HILLTOP COMPANIES, INC.  
HILLTOP BASIC RESOURCES, INC.  
HILLTOP CONCRETE  
MAYSVILLE READY MIX  
HILLTOP STONE, LLC  
HILLTOP BIG BEND QUARRY, LLC

ONE WEST FOURTH STREET  
SUITE 1100  
CINCINNATI, OH 45202

HILLTOP COMPANIES, INC.  
HILLTOP BIG BEND QUARRY, LLC  
1994 Paradise Bottom Rd  
Battletown, KY 40104  
BARGE LOADING FACILITY  
OHIO RIVER MILE 660  
MID PLAN VIEW

Date Rev: 04/30/14	Sheet 200808002
Drawn By R. Dan Corner, PE	Sheet 3 of 6
Phone (513) 684 - 8247	

# Approx 4520' HILLTOP Shore Line

# OHIO RIVER MILE 660

FLOW

[illegible]

**PLAN VIEW**  
**(East Property Line)**

**HILLTOP BIG BEND QUARRY, LLC PROPERTY**



NOTES: R. Dan Comer, P.E.  
4/30/2014

**NOTES:**

All barges will be secured as shown by either dolphins, cell or by 1 1/2" cables attached to deadmen as shown. 2" lock lines will be used as stern lines off of deadmen as shown.

Up to 47 barges may be in harbor at one time not including the crane barge, coal barge or work barge. They may be at various positions depending on how many are loaded, empty or are in assembly.

**THE CRANE BARGE, COAL BARGE, WORK BARGE AND 47 BARGES AS SHOWN ARE CURRENTLY PERMITTED**

**LRL-2008-950-pji.**

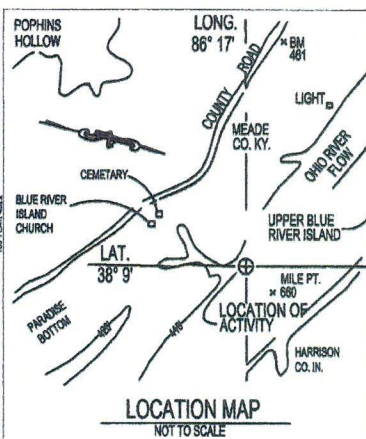

**HILLTOP COMPANIES, INC.**  
HILLTOP BASIC RESOURCES, INC.  
HILLTOP CONCRETE  
MAYSVILLE READY MIX  
HILLTOP STONE, LLC  
HILLTOP BIG BEND QUARRY, LLC

ONE WEST FOURTH STREET  
SUITE 1100  
CINCINNATI, OH 45202

**HILLTOP COMPANIES, INC.  
HILLTOP BIG BEND QUARRY, LLC  
1994 Paradise Bottom Rd  
Battletown, KY 40104  
BARGE LOADING FACILITY  
OHIO RIVER MILE 660  
EAST PLAN VIEW**

Rev: 04/30/14

Drawn By  
R. Dan Comer, PE

Phone  
(513) 684 - 8247

Street

200808001

Sheet 4 of 6



# NE HILLTOP Shore Line ER MILE 660

## MATCH LINE

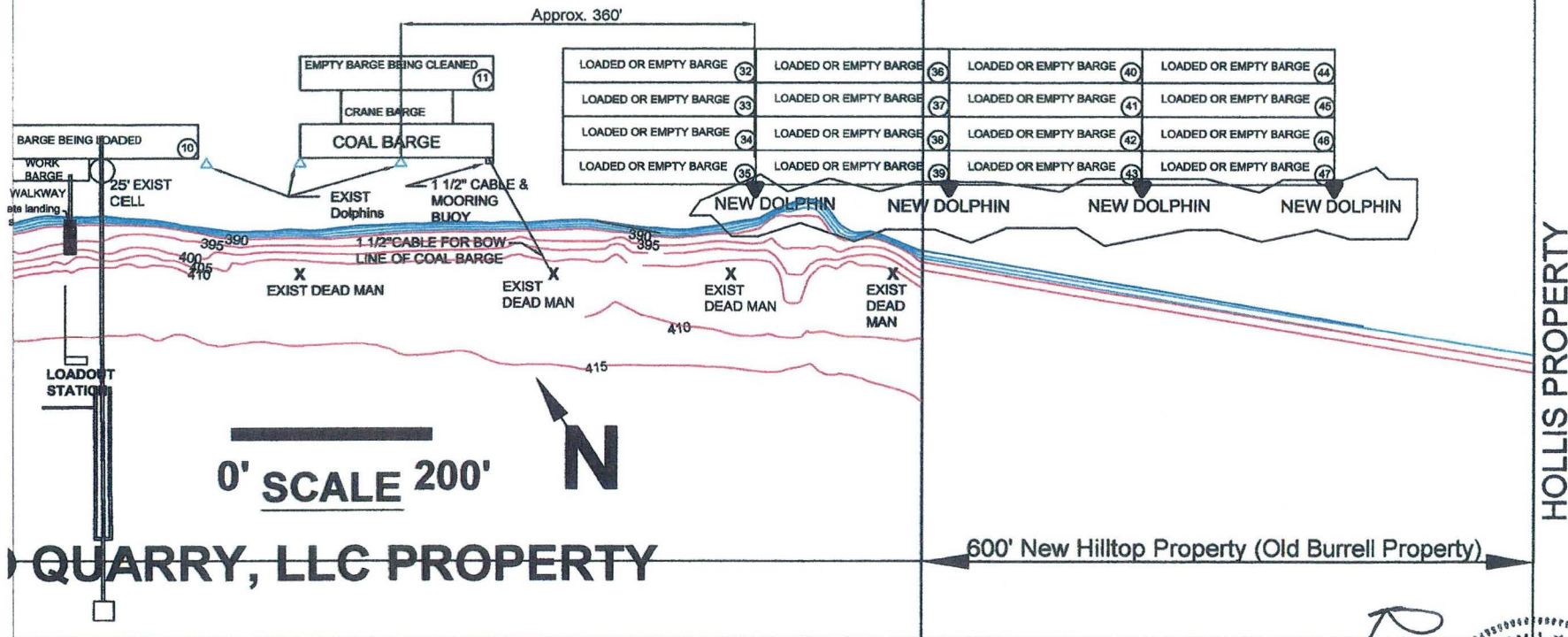

Date: Rev. 04/30/14  
 Drawn By: R. Dan Corner, PE  
 Title: (513) 684-8247  
 Sheet: 5 of 6

HILLTOP COMPANIES, INC.  
 HILLTOP BIG BEND QUARRY, LLC  
 1994 Paradise Bottom Rd  
 Battletown, KY 40104  
 BARGE LOADING FACILITY  
 OHIO RIVER MILE 660  
 TOTAL PLAN VIEW

HILLTOP COMPANIES, INC.  
 HILLTOP BASIC RESOURCES, INC.  
 HILLTOP CONCRETE  
 MAYSVILLE READY MIX  
 HILLTOP STONE, LLC  
 HILLTOP BIG BEND QUARRY, LLC  
 ONE WEST FOURTH STREET  
 SUITE 1100  
 CINCINNATI, OH 45202

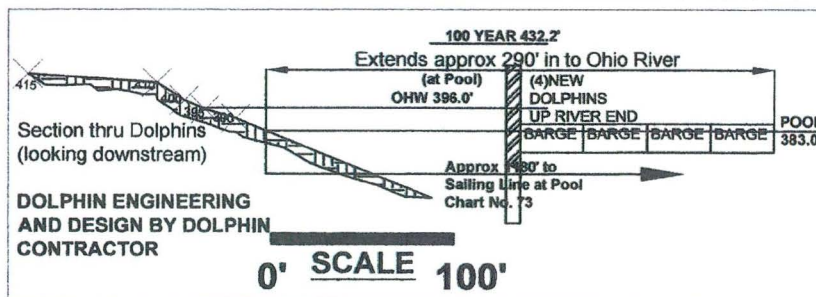

R. Dan Corner, PE  
 4/30/2014  
 R. D. CORNER  
 16508  
 REGISTERED PROFESSIONAL ENGINEER  
 STATE OF KENTUCKY

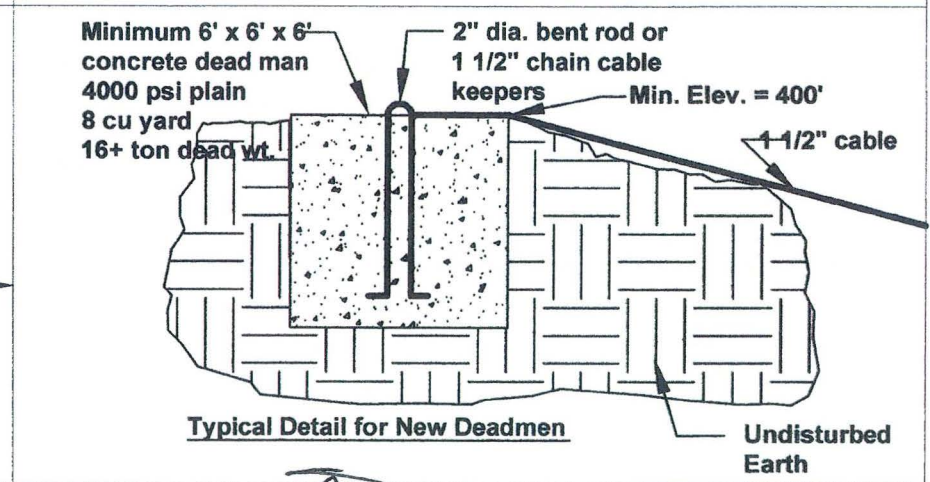
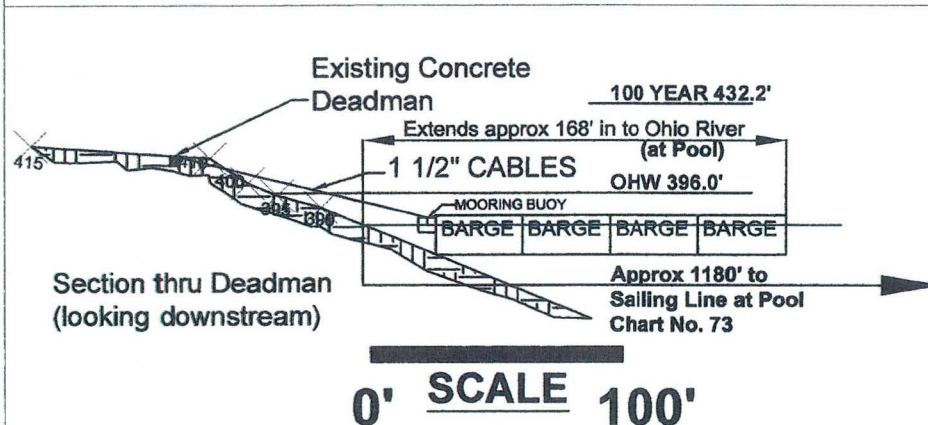
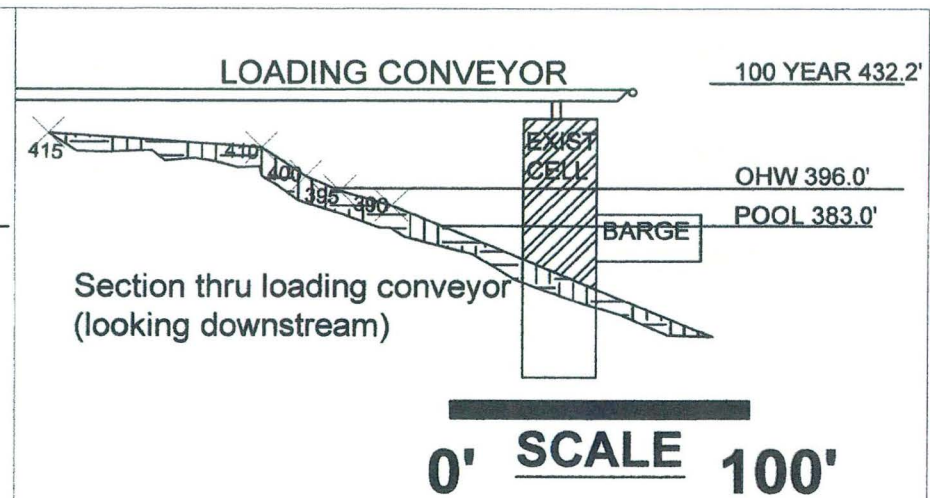
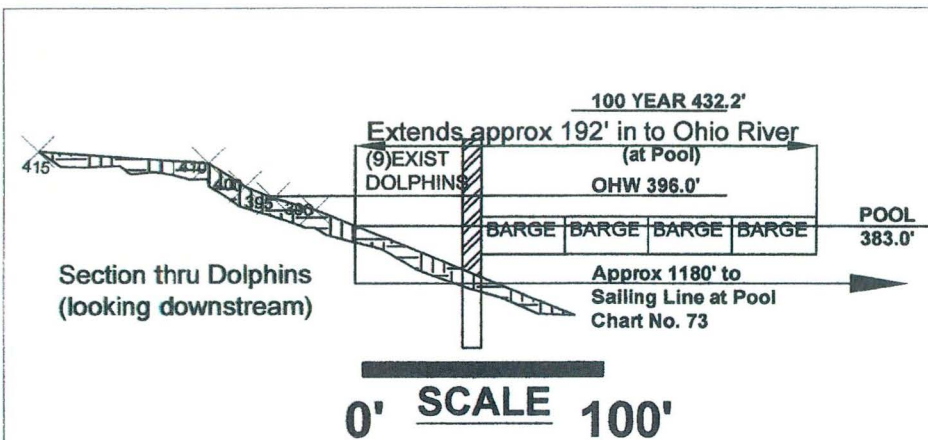

Drawn By R. Dan Corner, P.E.	Sheet 200808004
Check By (613) 864 - 8247	Sheet 6 of 6

HILLTOP COMPANIES, INC.  
HILLTOP BIG BEND QUARRY, LLC  
1994 Paradise Bottom Rd  
Bartlettown, KY 40104  
BARGE LOADING FACILITY  
OHIO RIVER MILE 660  
DETAILS

HILLTOP COMPANIES, INC.  
HILLTOP BASIC RESOURCES, INC.  
HILLTOP CONCRETE  
MAYSVILLE READY MIX  
HILLTOP STONE, LLC  
HILLTOP BIG BEND QUARRY, LLC  
ONE WEST FOURTH STREET  
SUITE 1100  
CINCINNATI, OH 45202

NOTES:  
See notes Sheet 4 of 6  
See Section view on Sheet 5 of 6  
DOLPHIN ENGINEERING AND DESIGN  
BY DOLPHIN CONTRACTOR

R. Dan Corner, P.E.  
4/30/2014  
STATE OF KENTUCKY  
R. D. CORNER  
REGISTERED ENGINEER  
16508